

PNW MANUAL HAND WINCH



APPLICATIONS

PNW type manual hand Winch is a new model of manual winch. Compared with other winches, it is more convenient in use, more easy in operation and more widely use. It is mainly applied for cross-country vehicle, agriculture vehicle, pleasure-boat and other special vehicle. It is the device of self-protection and pulling of vehicles and boats, and also may be used for saving in snowfield, marshland, desert, sea beach, muddy patch and other adverse circumstances. It may be operated for clearing away obstacles, pulling mater and installation. It is the necessary safe device of mine, environment protection, forestry transportation, fire fighting and other open field.

CHARACTERISTICS

The main advantages of PNW type manual hand Winch in manufacturing and use are as follows:

1. Adopting lever handle, either may shake operation along the whole circle, or may swing operation at any angle in the any position of circle. It has unique advantage in the narrow space.
2. The gear box and braking mechanism are designed with sealed structure to avoid foreign matter entering the gear box and braking mechanism, and affect the normal operation.
3. The braking material is made of environment material and is more suitable for the normal operation.
4. The new brake pawls designed for more better ensuring the stability of braking.
5. The Handle is adopted free structure to adjust the length of Handle freely.
6. The ratchet is big enough to contain more wire rope and more suitable for the operation in deep well and drawing of long distance.

THE EXPLODED VIEWS FOR PNW TYPE MANUAL HAND WINCH

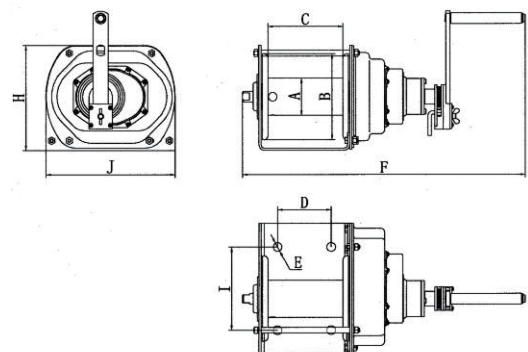
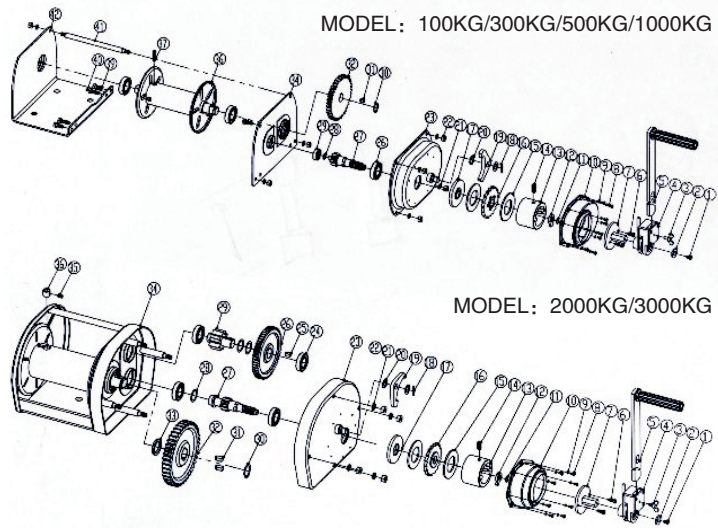

PNW TYPE MANUAL HAND WINCH SPECIFICATIONS

MODEL	PNW-100	PNW-300	PNW-500	PNW-1000	PNW-2000	PNW-3000
CAPACITY	100KG	300KG	500KG	1000KG	2000KG	3000KG
SATE WORKING LOAD T	0.1	0.3	0.5	1	2	3
ADOPTED WIRE ROPE DIA(MM) × LENGTH(MM)	1.225	3.675	6.125	12.25	24.5	36.75
SPEED RATIO	Φ5 × 30	Φ6.3 × 30	Φ6.3 × 40	Φ8 × 40	Φ9 × 40	Φ12.5 × 40
THE MAX LENGTH OF LINK-POLE ACTION MM	1:1	2.88:1	4.33:1	12.19:1	22.68:1	29.16:1
MIN FORCE OF HAND TURN	240	350	350	350	350	350
DIMEN SIONS (MM)	A	115	110	120	120	180
	B	Φ48	Φ60	Φ60	Φ76	Φ90
	C	Φ110	Φ125	Φ140	Φ175	Φ190
	D	116	150	150	154	195
	E	80	100	100	110	155
	F	Φ11	Φ15	Φ15	Φ18	Φ18
	G	402	403	403	443	490
	H	147	174	182	214	230
	I	90	130	130	170	170
	J	160	220	245	266	300
NET WEIGHT KG	6.9	11.8	14.4	19.7	25.1	44.3