

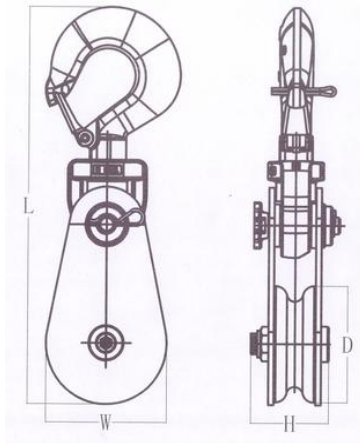

HOOK TYPE HEAVY DUTY SNATCH BLOCK

Product features :

- 1) Comply to ASME standard, safety factor is 4:1
- 2) High strength alloy steel forging, and quenched and tempered heat treatment, stronger tension and more safety.
- 3) Traceability : tracking products testing and certification number and batch number of the product.
- 4) Easy to maintain: configuration for easy operation and maintenance and extension of the service life of carbon steel wheels and butter nozzle.
- 5) JDB bronze bearing : self lubrication, not need oiling often, the general set of 10 times of the service life of general bronze.
- 6) Strong corrosion resistance: spray surface treatment.



Model	Working Load Limit (Ton)	Sheave Diam (in)	Wire Rope Size(mm)	Weight Each (KG)	W(mm)	H(mm)	L(mm)
H21-2T-75	2T	3"	7-9	2.4	76	54	237
H21-4T-115	4T	4½"	10-12	6.8	116	71	355
H21-8T-152	8T	6"	16-19	12.2	155	90	495
H21-8T-200	8T	8"	20-22	20	205	103	551
H21-10T-152	10T	6"	16-19	17	155	95	520
H21-10T-250	10T	10"	24-26	39	260	115	562
H21-12T-250	12T	10"	24-26	41.5	260	115	705
H21-12T-300	12T	12"	24-26	58	307	133	801
H21-15T-250	15T	10"	19-22	56	260	135	713
H21-15T-300	15T	12"	19-22	60	307	135	804
H21-20T-250	20T	10"	25-29	60	257	150	777
H21-20T-300	20T	12"	25-29	68	307	150	833
H21-22T-355	22T	14"	29-32	115	360	140	960
H21-22T-406	22T	16"	29-32	125	410	140	1027
H21-30T-406	30T	16"	32-35	188	415	140	1033
H21-30T-508	30T	20"	32-35	237	515	184	1070
H21-50T-609	50T	24"	46-50	408	625	240	1445